

# AUTOMATA PENGUIN!



INNOVATION WYRKSHOP

**INNOVATEHER**

**CLUB**

# MATERIALS PROVIDED

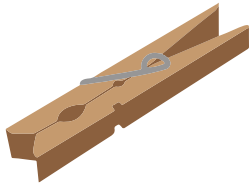

clothespin



straightened  
paperclip

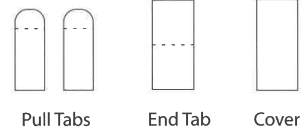

Body—Side



Body



Body—Side



Beak

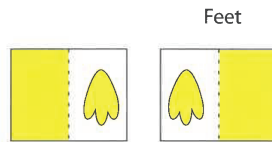

Feet



Wing



Wing

# MATERIALS NEEDED



patience



glue  
(glue stick works too!)

## STEP 1:

Glue the inside of the wing, and fold the card down to make a double thickness card. Repeat with other wing then cut both out.

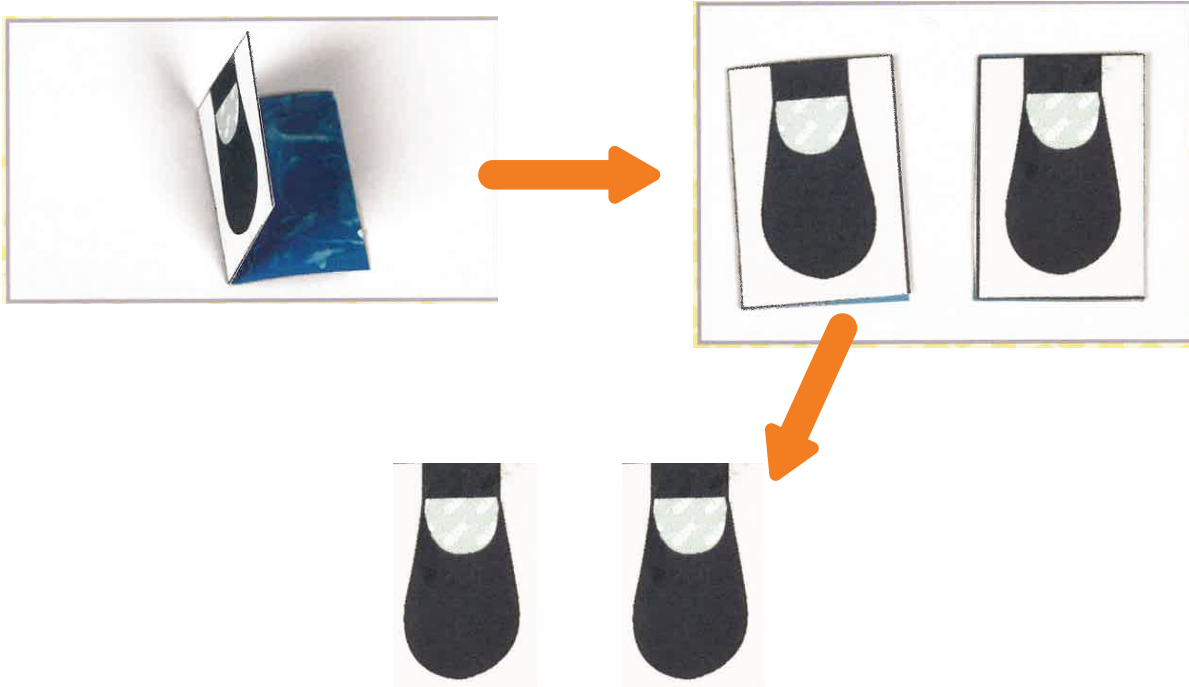

## STEP 2:

Glue the tab over the end of the wire, and glue it down. Wait until the glue dries.

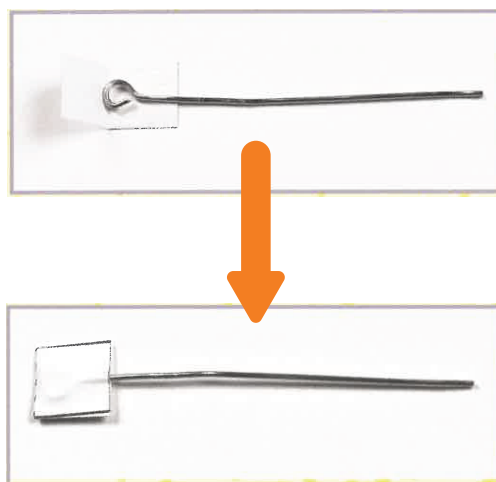

**STEP 3:** Glue and cut out the feet the same way that you did in Step 1.



**STEP 4:** Glue the pull tabs to the wings.



**STEP 5:** Thread the wing through the body and glue it to the semicircle tab. Repeat on the other body with the other wing.

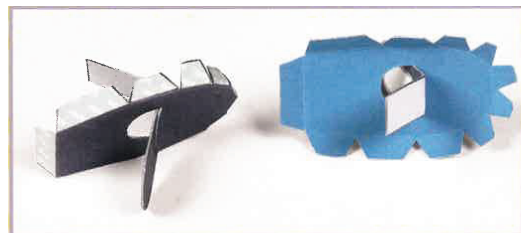
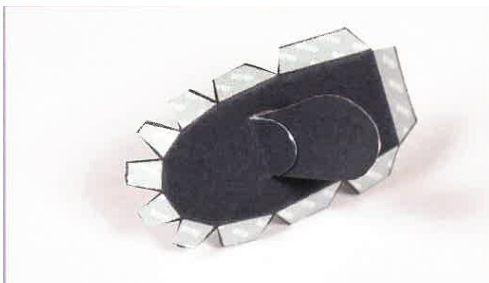



**STEP 6:** Glue the front of the body to the sides



**STEP 7:** Glue the wire tab onto one of the wing pull tabs. Once it's dry glue the other side of the wire tab to the other wing pull tab.

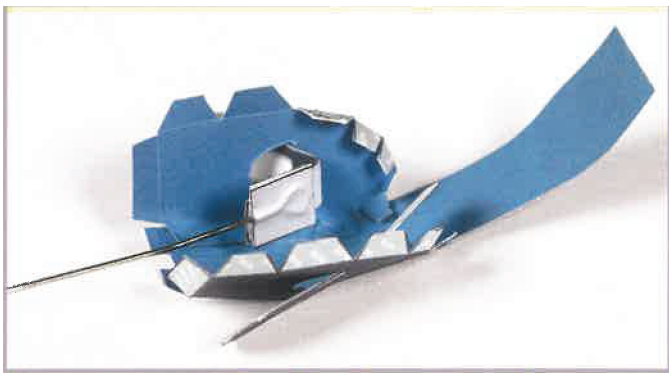

**STEP 8:** Glue the rest of the body to the sides, and then glue on the beak and the feet.



**STEP 9:** Stick your penguin and wire through the hole, then glue your penguin to the clothespin.



**STEP 10:** Carefully bend the wire as close to 90° as you can. Glue the remaining tab over the wire and let dry.



**STEP 11:** Once completely dry start flapping those penguin wings!

